

6.4. ROCK GUARD



LEV04\_MOTOR REPLACEMENT GUIDE  
<https://vimeo.com/932808813?share=copy>

	PART NAME		PART #	ALT PART #	QTY	DESCRIPTION	TOOL	TORQUE		NOTES
								Nm	in-lbf	
A	A1	Rock Guard	S229900026		1	MOTOR COVER,PA TRAIL FSR H2				
	A2	Rock Guard Bolt			2	M6 x 13 mm x 1.0 mm P	4 mm hex	5	44	Apply to contact surface /avoid the thread

6.5. BATTERY COVER ASSEMBLY





	PART NAME		PART #	ALT PART #	QTY	DESCRIPTION	TOOL	TORQUE		NOTES
								Nm	in-lbf	
A	Main Battery		98924-5681		1	SBC - B26   SBC - B34 SPECIALIZED X2-840 BATTERY (SERVICE-AM)				
B	B1	Battery Bracket	<a href="#">S2446800005</a>		1	MAIN BATTERY, TOP MOUNTING BRACKET, W/ BOLTS				
	B2	Battery Bracket Bolt			4	M4 x 8 mm x 0.7 mm P	2.5 mm hex	2	18	
C	C1	Battery Cover	<a href="#">Click here for Battery door table</a>		1	BTRY COVER,MTB,PA TRAIL FSR H1.2				Model and colour specific
	C2	Battery Cover Bolt			1	M8 x 14 mm x 1.0 mm P	4 mm hex	5	44	With O-Ring
D	Battery Cover Bolt Insert		<a href="#">S240500011</a>		1	THREADED INSERT FOR BATTERY COVER BOLT	5 mm hex	8	70	Carbon Frame Only

7. DRIVETRAIN

7.1. CHAINGUIDE ASSEMBLY



	PART NAME		PART #	ALT PART #	QTY	DESCRIPTION	TOOL	TORQUE		NOTES
								Nm	in-lbf	
A	A1	Outer Plate	S221200007		1	CHN GUIDE, OUTER PLATE, PA TRAIL FSR F1				
	A2	Outer Plate Nut			1	M8 x 1 mm P Nut	5 mm hex	3.5	30	Adjust position according to chain wheel size
	A3	O-Ring			1	9 mm ID x 1.5 mm Thk O-Ring				
	A4	Inner Plate			1	CHN GUIDE, INNER PLATE, PA TRAIL FSR F1				
	A5	Back Plate			1	CHN GUIDE, BACK PLATE, PA TRAIL FSR H2				
	A6	Spacer Outer			1	8.2 mm ID x 12 mm OD x 1 mm Thk				
	A7	Spacer Inner			3	8.2 mm ID x 12 mm OD x 0.5 mm Thk				
	A8	Guide Bolt			1	M8 x 11 mm x 1 mm P Slotted				
	A9	Dowel Pin			1	3 mm OD x 10 mm				
	A10	Mounting Bolt			1	M6 x 16 mm x 1 mm P	4 mm hex	3.5	30	

7.2. SPIDER & CHAINWHEEL

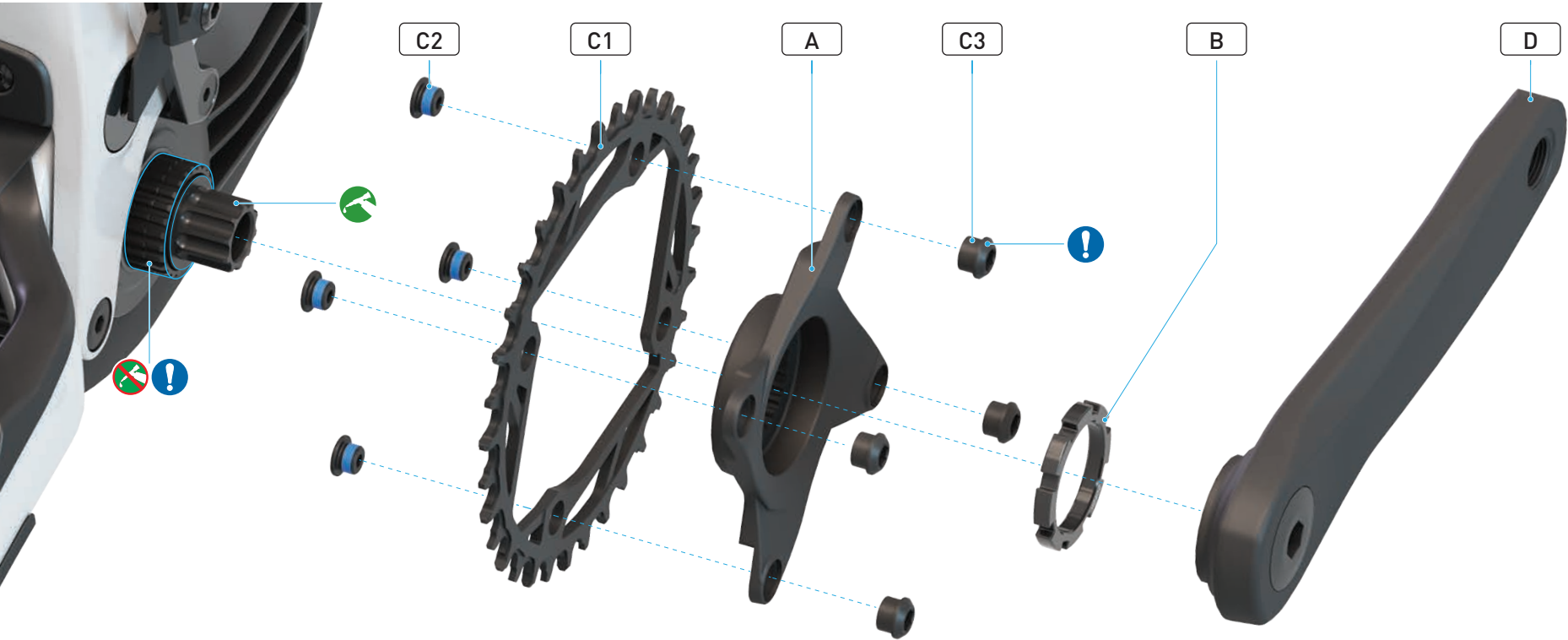

	PART NAME		PART #	ALT PART #	QTY	DESCRIPTION		TOOL	TORQUE		NOTES
									Nm	in-lbf	
A	Spider		<a href="#">S225100005</a>		1	SPR TURBO, SPECIALIZED 3.1 MOTOR SPIDER, 104 BCD, 4-BOLT, 55MM CL, ALLOY					DO NOT apply grease to the spider spline before assembly of the spider and lockring.
B	Spider Lockring		<a href="#">S245100001</a>		1	SPR SUB, SPECIALIZED 3.1 MOTOR, SPIDER LOCKRING	Park Tool BBT-18	20	177		
C	C1	Chainwheel	<a href="#">S231400002</a>			CHR TURBO, 34T, T-TYPE 12-SPD, 4-BOLT, 104BCD, 1X RING, STEEL, SRAM					
	C2	Chainwheel Bolt			4						
	C3	Chainwheel Nut			4						Only use the supplied short chainring nuts/bolts to prevent them striking the chain guide.
	Crank Arm - Alloy		<a href="#">S241600011</a>		2	SRAM FC X0 BROSE ISIS M15SE 155 ARMS ONLY		8 mm	54	478	155 mm, Alloy / Apply grease to ISIS spline.
	Crank Arm - Carbon		<a href="#">S241600006</a>		2	SRAM FC XX BROSE ISIS M15SE 160 ARMS ONLY, CARBON		8 mm	54	478	160 mm, Carbon / Apply grease to ISIS spline.

**CAUTION:** DO NOT apply grease to the spider spline before assembling the spider and spider lockring.

**CAUTION:** Only use the supplied chainring nut (5 mm) to prevent it from striking the chain guide once assembled.



8. HEADSET STACK

8.1. HEADSET



ADJUSTABLE GEOMETRY CHANGES			
ADJUSTMENT POINT	CHAINSTAY LENGTH (A)	BOTTOM BRACKET HEIGHT (B)	HEAD TUBE ANGLE (C)
Headset Cup (0°) (Default)	435 mm	350 mm	64.5°
Headset Cup (-1°)	-	-2 mm	-1°
Headset Cup (+1°)	-	-2 mm	-1°

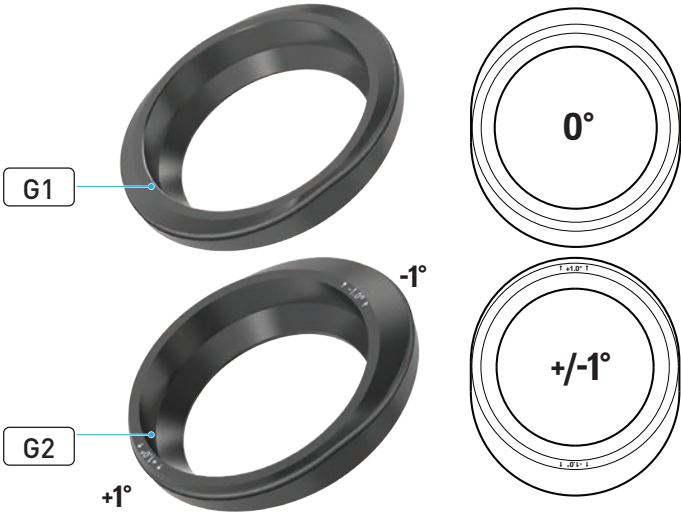

LEV04 HEADSET, STEM, AND STEERER TUBE PROTECTOR ASSEMBLY GUIDE

<https://player.vimeo.com/video/932808853>

	PART NAME		PART #	ALT PART #	QTY	DESCRIPTION	TOOL	TORQUE		NOTES
								Nm	in-lbf	
A	Top Cap		<a href="#">S242500004</a>		1	H2387 ALLOY WITH O-RING				
B	Micro Shim				1	MW006 SHIM				
C	Compression Ring				1	H2081A (No. 8-2) ALLOY COMPRESSION RING				
D	Upper Headset Bearing				1	UPPER BEARING MR215 1-1/8" 45°				
E	Lower headset Bearing			<a href="#">S092500001</a>	1	LOWER BEARING MR170 1,5" 45°				
F	Split Crown Race				1	CROWN RACE H6106				 Split to face the rear of the bicycle
G	G1	Headset Cup (0°) (Default)	<a href="#">S212500015</a>		1	HDS SUB, MY22 LEVO HEADSET CUPS KIT, W/ 0-DEG AND +/-1-DEG CUPS				
	G2	Headset Cup (+1°/-1°)			1					
	G3	Lower Headset Cup			1					

## 8.2. FORK ASSEMBLY

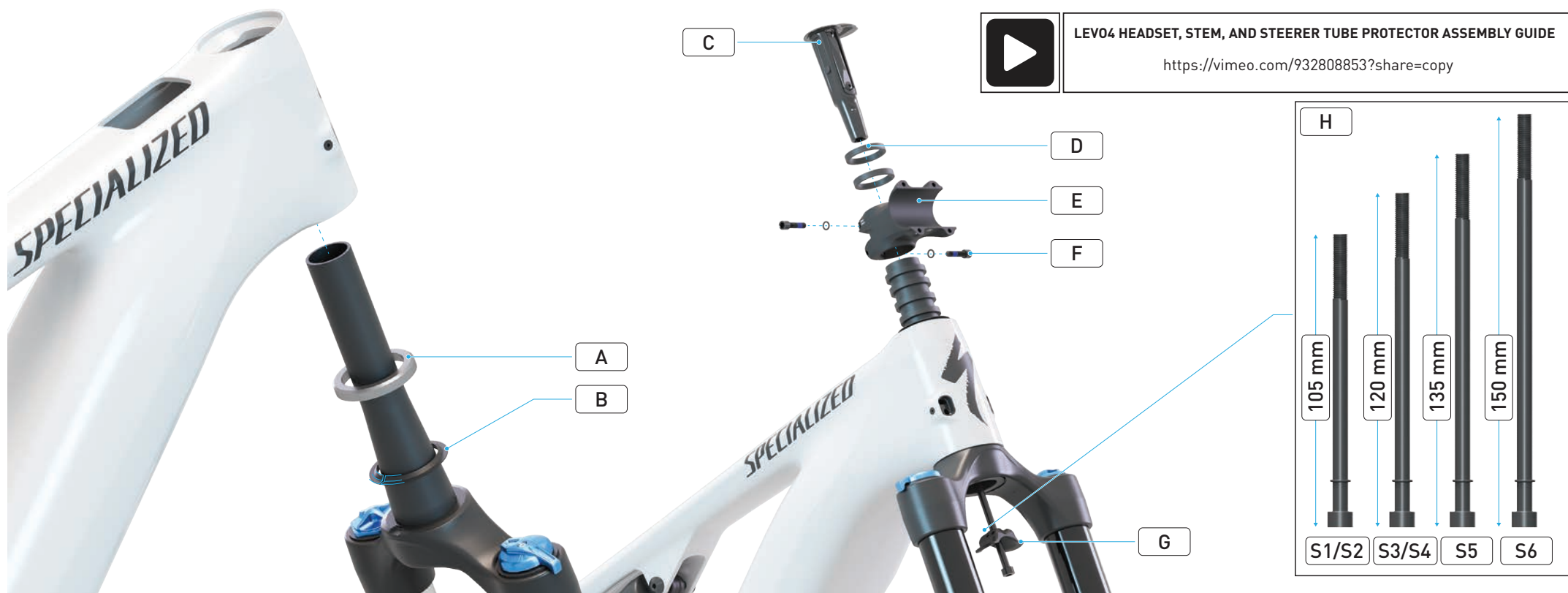

	PART NAME	PART #	ALT PART #	QTY	DESCRIPTION	TOOL	TORQUE		NOTES
							Nm	in-lbf	
A	Lower Bwearing	Part of <a href="#">S242500004</a>	S092500001	1	LOWER BEARING MR170 1,5" 45°				
B	Split Crown Race			1	CROWN RACE H6106				Split to face the rear of the bicycle
C	Swat™ Conceal Carry Mtb Tool	<a href="#">53224-1170</a>		1	SWAT™ Conceal Carry MTB Tool-Narrow Cap				
D	Headset Spacer 5 mm			6	34 mm OD x 28.6 mm ID x 5 mm H				2 x above, 4 x below stem
E	Stem	Model Specific		1	40 mm - Model Specific				
F	Stem Steerer Bolts			2					Follow torque value etched onto the stem
G	SWAT™ Bow Tie Anchor	Part of <a href="#">53224-1170</a>		1					
H	SWAT™ Anchor Bolt 105 mm	<a href="#">S185300016</a>		1	ANCHOR BOLT W/ CHAIN PIN DRIVER - 105MM LENGTH				Frame size specific.
	SWAT™ Anchor Bolt 120 mm	<a href="#">S185300017</a>		1	ANCHOR BOLT W/ CHAIN PIN DRIVER - 120MM LENGTH				
	SWAT™ Anchor Bolt 135 mm	<a href="#">S182500009</a>		1	ANCHOR BOLT W/ CHAIN PIN DRIVER - 135MM LENGTH				
	SWAT™ Anchor Bolt 150 mm			1	ANCHOR BOLT W/ CHAIN PIN DRIVER - 150MM LENGTH				

8.3. SWAT BAG MOUNT

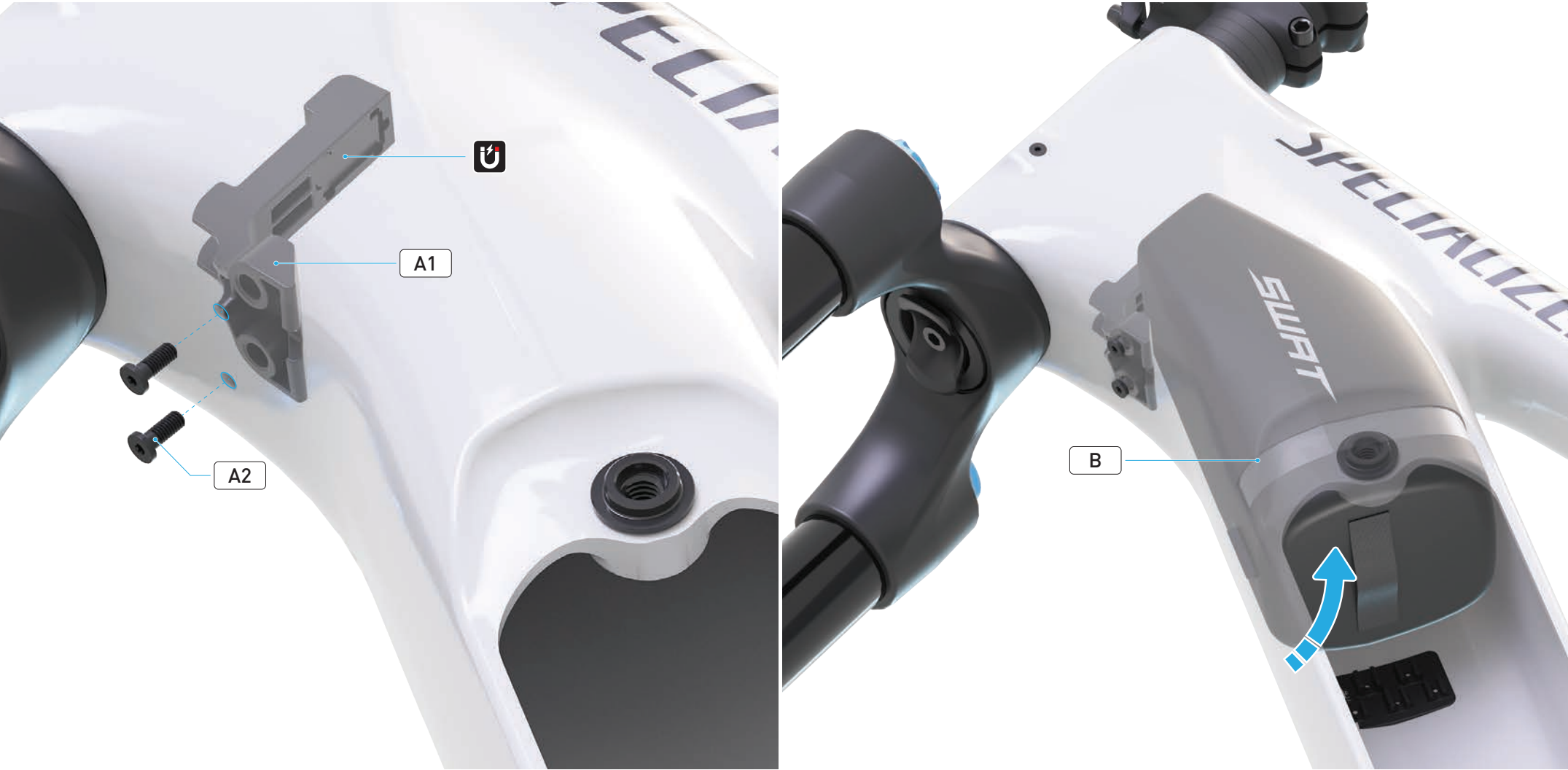

	PART NAME		PART #	ALT PART #	QTY	DESCRIPTION	TOOL	TORQUE		NOTES
								Nm	in-lbf	
A	A1	Swat Bag Mounting Bracket	<a href="#">S249900022</a>		1	SWAT,HOOK,MTB,PA TRAIL FSR H2				Magnetic
	A2	Swat Bag Mounting Bracket Bolt			2	M4 x 10 mm x 0.7 mm P	T10 Tox	1.5	13	 Apply to contact surface /avoid the thread
B	Swat Bag - Small		<a href="#">S249900024</a>		1	SWAT BAG,MTB,PA TRAIL FSR H2,S2/S3				Frame Size S2/S3
	Swat Bag - Large		<a href="#">S249900023</a>		1	SWAT BAG,MTB,PA TRAIL FSR H2,S4/S5/S6				Frame Size S4/S5/S6

9. MASTERMIND T3

9.1. DISPLAY INSTALLATION

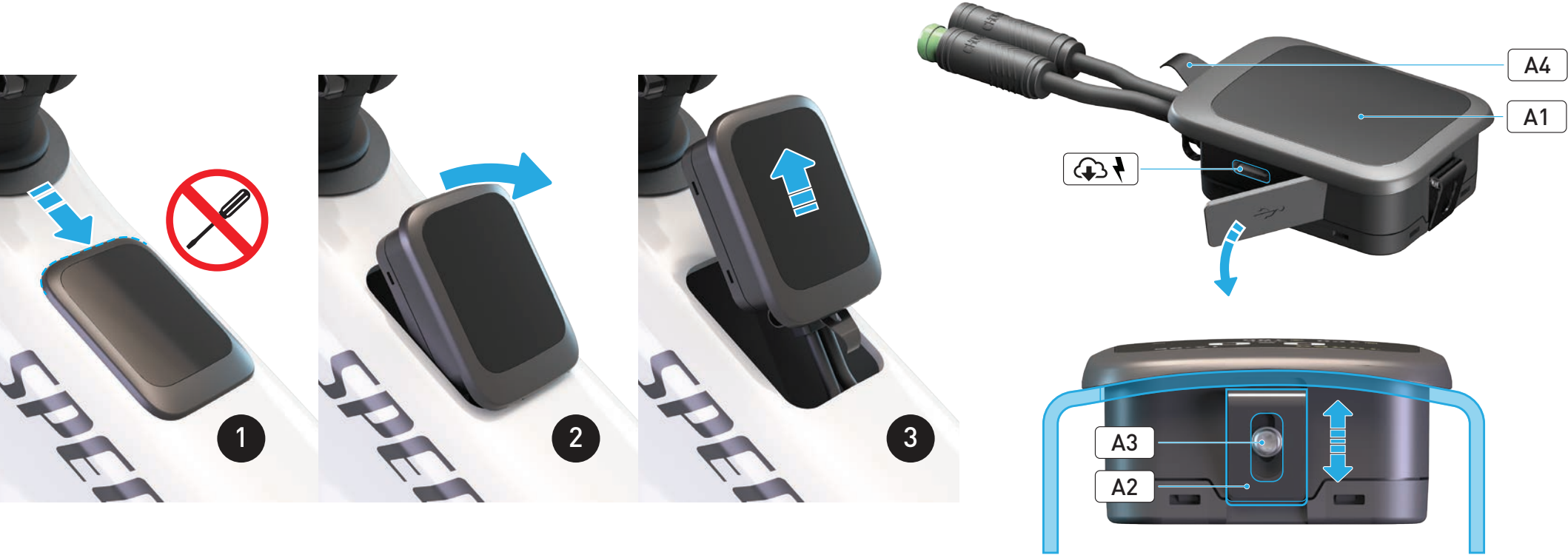

	PART NAME		PART #	ALT PART #	QTY	DESCRIPTION	TOOL	TORQUE		NOTES
								Nm	in-lbf	
A	A1	MasterMind T3 Display	<a href="#">S226800023</a>		1	DISPLAY,TCU3,PA				
	A2	Front Leaf Spring			1	0.4 mm SUS304 DACROMET COATED				
B	A3	Front Leaf Spring Bolt			1	M4 x 6 mm x 1.7 mm P	T6	0.2	1.8	Use with supplied lock washer
	A4	Rear Leaf Spring			1	0.4mm SUS304 DACROMET COATED, SPRING FORCE (13N)				Adjust according to frame thickness

**i** Take care when installing the Mastermind T3 Display to not scrath the paint finish with the front spring.



9.2. TOP TUBE CABLE WRAP

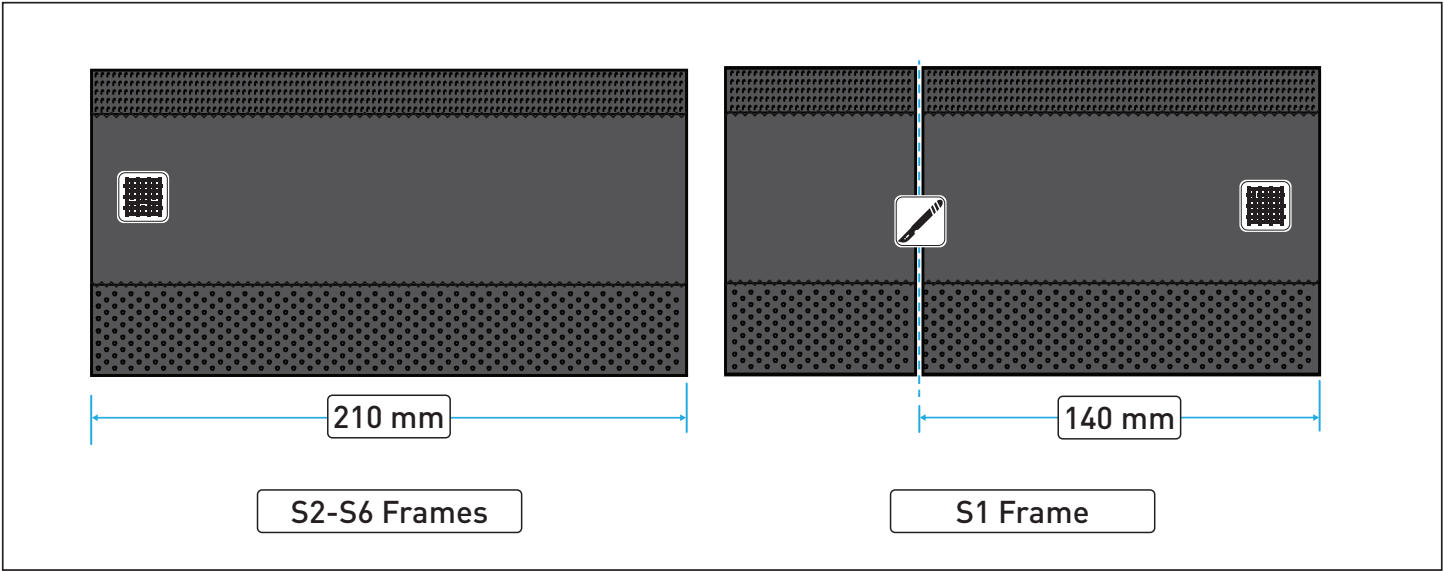

	PART NAME	PART #	ALT PART #	QTY	DESCRIPTION	TOOL	TORQUE		NOTES
							Nm	in-lbf	
A	Top Tube Cable Wrap	<a href="#">S249900025</a>		1	PROTECTOR, TOP TUBE Y-SPLITTER & CABLE WRAP				

- Always place cables inside the coated side of the cable wrap.
- On Size S1 Alloy frames the cable wrap needs to be trimmed to 140 mm to fit in the smaller top tube space.

9.3. ICR PORTS

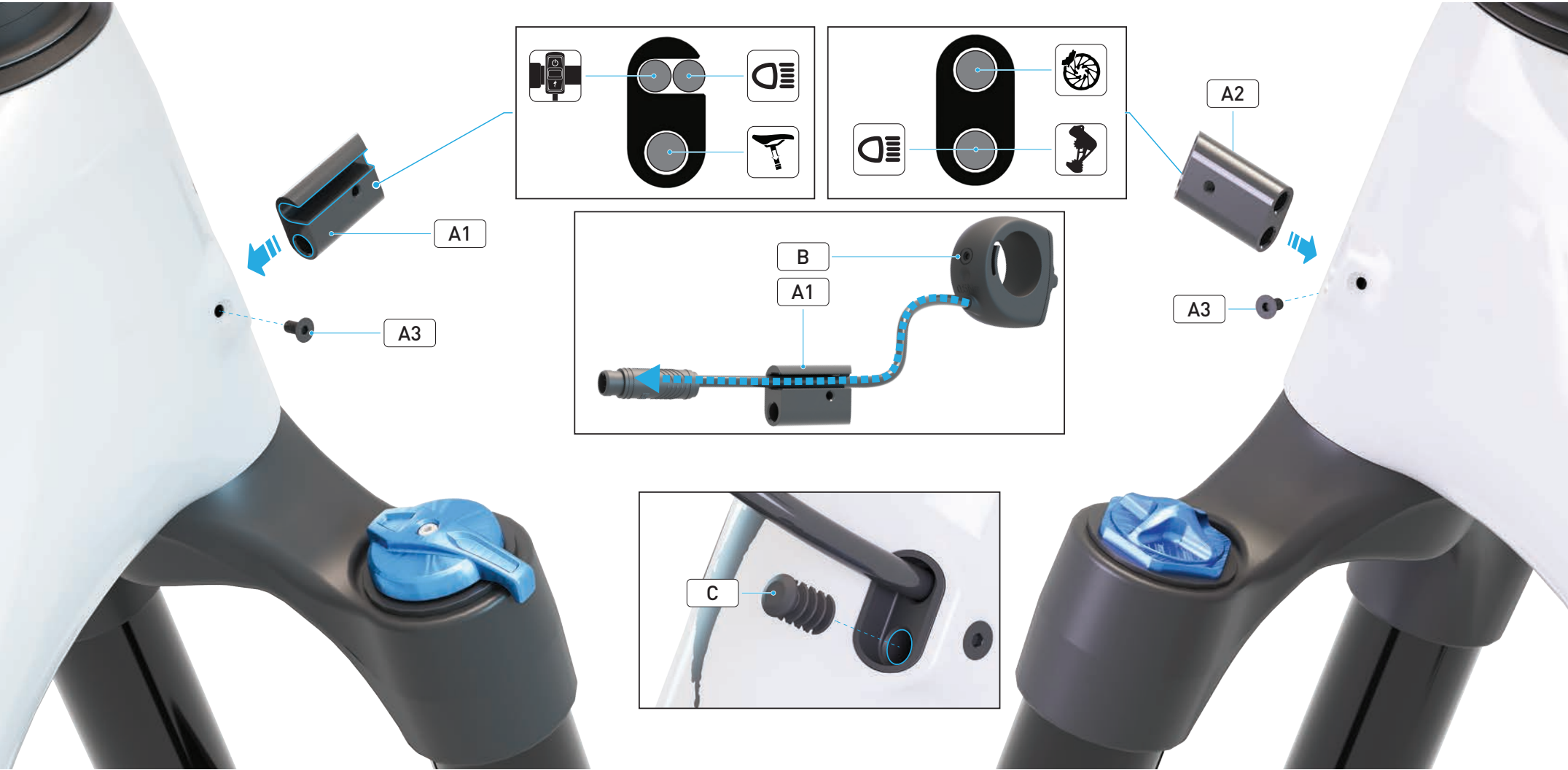

	PART NAME		PART #	ALT PART #	QTY	DESCRIPTION	TOOL	TORQUE		NOTES
								Nm	in-lbf	
A	A1	Headtube ICR Port - NDS	<a href="#">S246500007</a>		1	ICR INSERT NDS,PA TRAIL H1,2X 5.5MM,M3				
	A2	Headtube ICR Port - DS			2	ICR INSERT DS,PA TRAIL H1,4.3MM SLOT,1X 5.5MM,M3				
	A3	Headtube ICR Port - Bolt			2	M3 x 6 mm x 0.5 mm P	2 mm hex	0.7	6	Apply to contact surface /avoid the thread
B	T3 Remote		<a href="#">S226800017</a>		1	MASTERMIND T3 HANDLEBAR REMOTE				
C	ICR Port Grommet		<a href="#">S246500011</a>		1	PLUG, ICR ENTRY/EXIT PORT, RIBBED SOLID RUBBER PLUG				Use to fill unused ICR ports

10. RANGE EXTENDER & BOTTLE CAGE

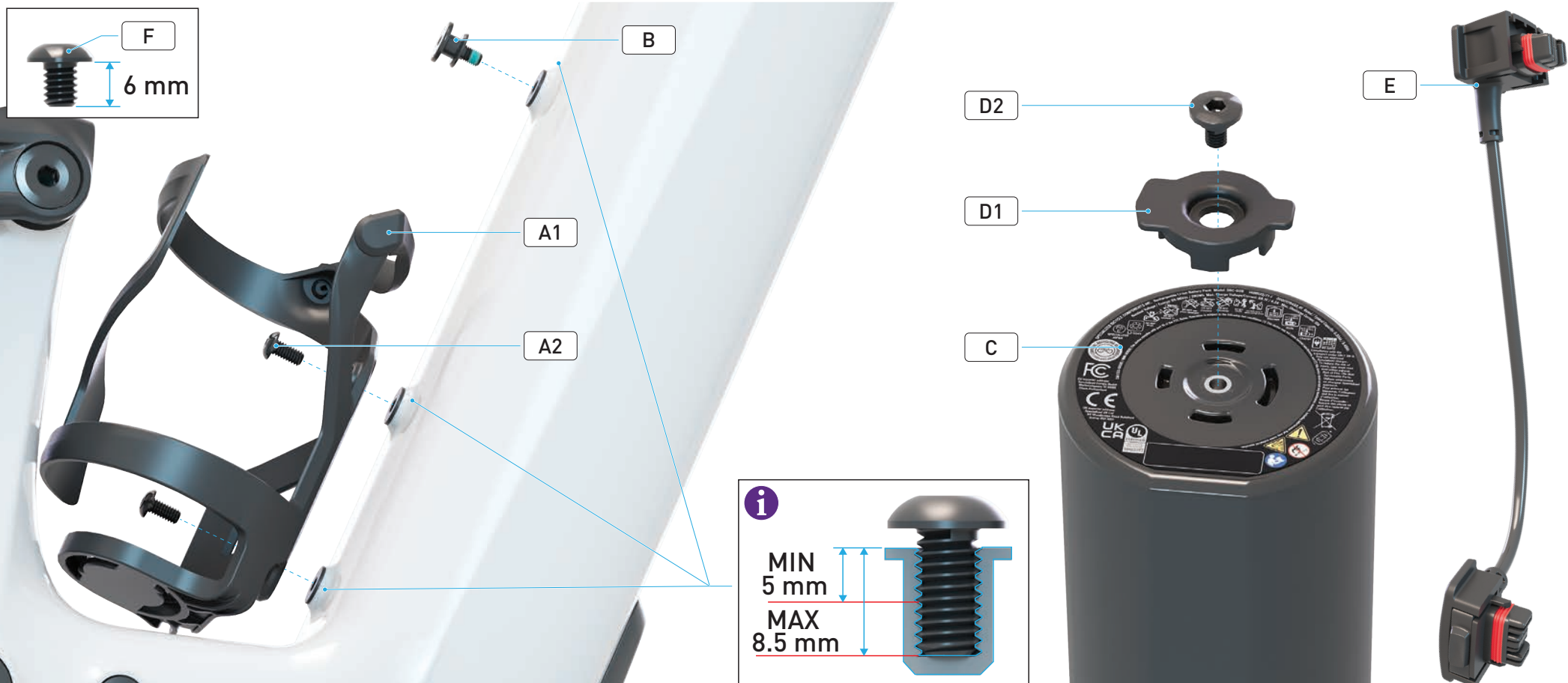

	PART NAME		PART #	ALT PART #	QTY	DESCRIPTION	TOOL	TORQUE		NOTES
								Nm	in-lbf	
A	A1	Bottle Cage			1	SPECIALIZED FULL POWER 3.1 SYSTEM, ZEE CAGE FOR RANGE EXTENDER				
	A2	Bottle Cage Bolt	<a href="#">S249900016</a>		2	M5 x 10 mm x 0.8 mm P	3 mm hex	2.2	19	
		S-Works Bottle Cage Bolt	<a href="#">S230500005</a>		2	M5 x 10 mm x 0.8 mm P	3 mm hex	2.2	19	
B	Downtube Anchor Bolt		<a href="#">S240500012</a>		1	M5 x 7 mm x 0.8 mm P	3 mm hex	2.2	19	
C	Range Extender		98924-5680		1	SPECIALIZED X2-280 BATTERY (SERVICE-AM) SINGLE PACK				
D	D1	Range Extender Bracket			1	ICR INSERT DS,PA TRAIL H1,4.3MM SLOT,1X 5.5MM,M3				
	D2	Range Extender Bracket Bolt	<a href="#">S246800006</a>		1	M5 x 6 mm x 0.8 mm P	4 mm hex	2.5	22	
E	Range Extender Cable		98924-5660		1	Pluto RE Cable - 210mm				
F	Extra Short Bottle Cage Bolt		<a href="#">S240500013</a>		2	M5 x 6 mm x 0.8 mm P	3 mm hex	2.2	19	Use with aftermarket bottle cage

# 11. WIRING DIAGRAMS

## 11.1. BASE MODEL

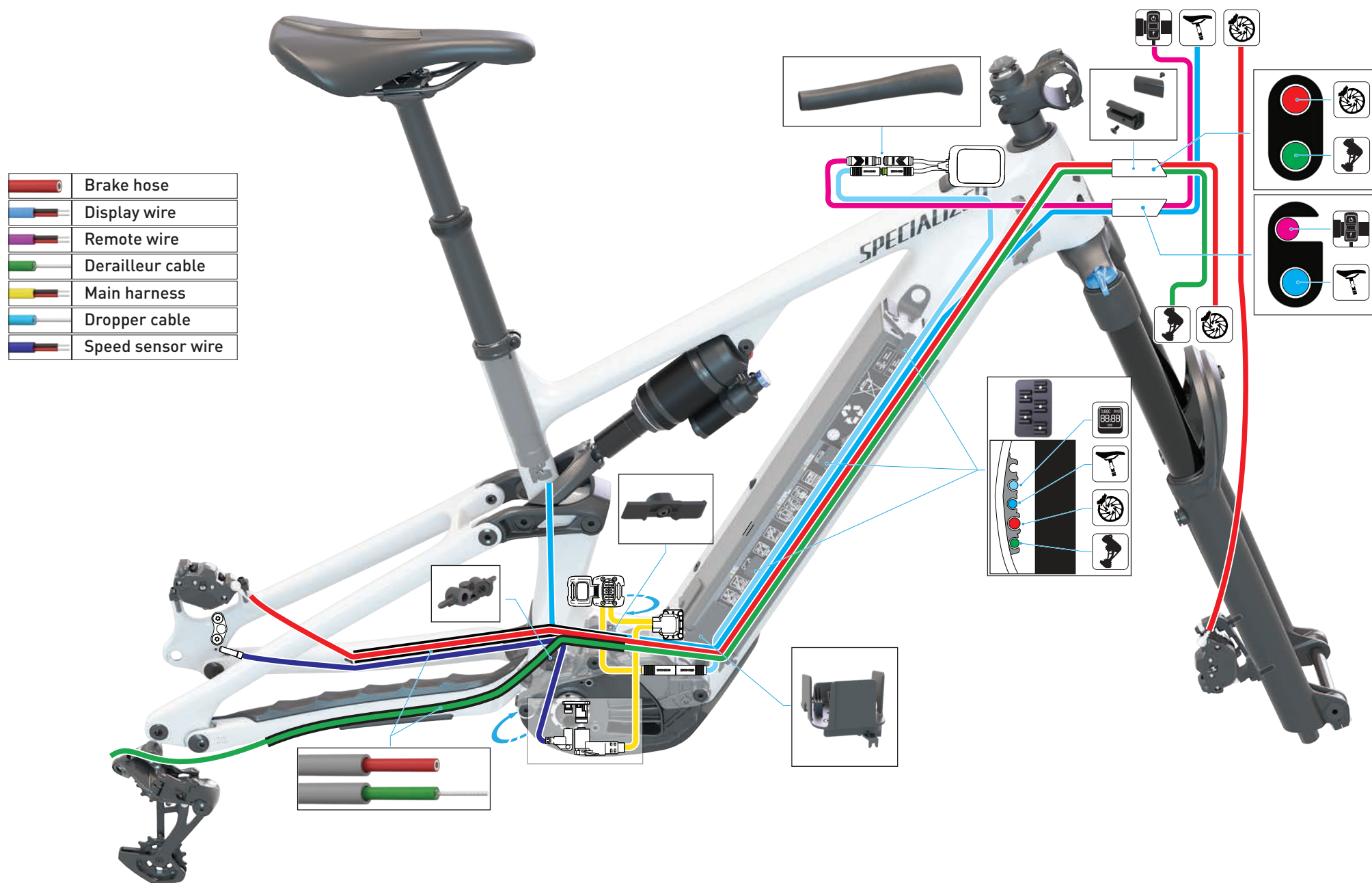



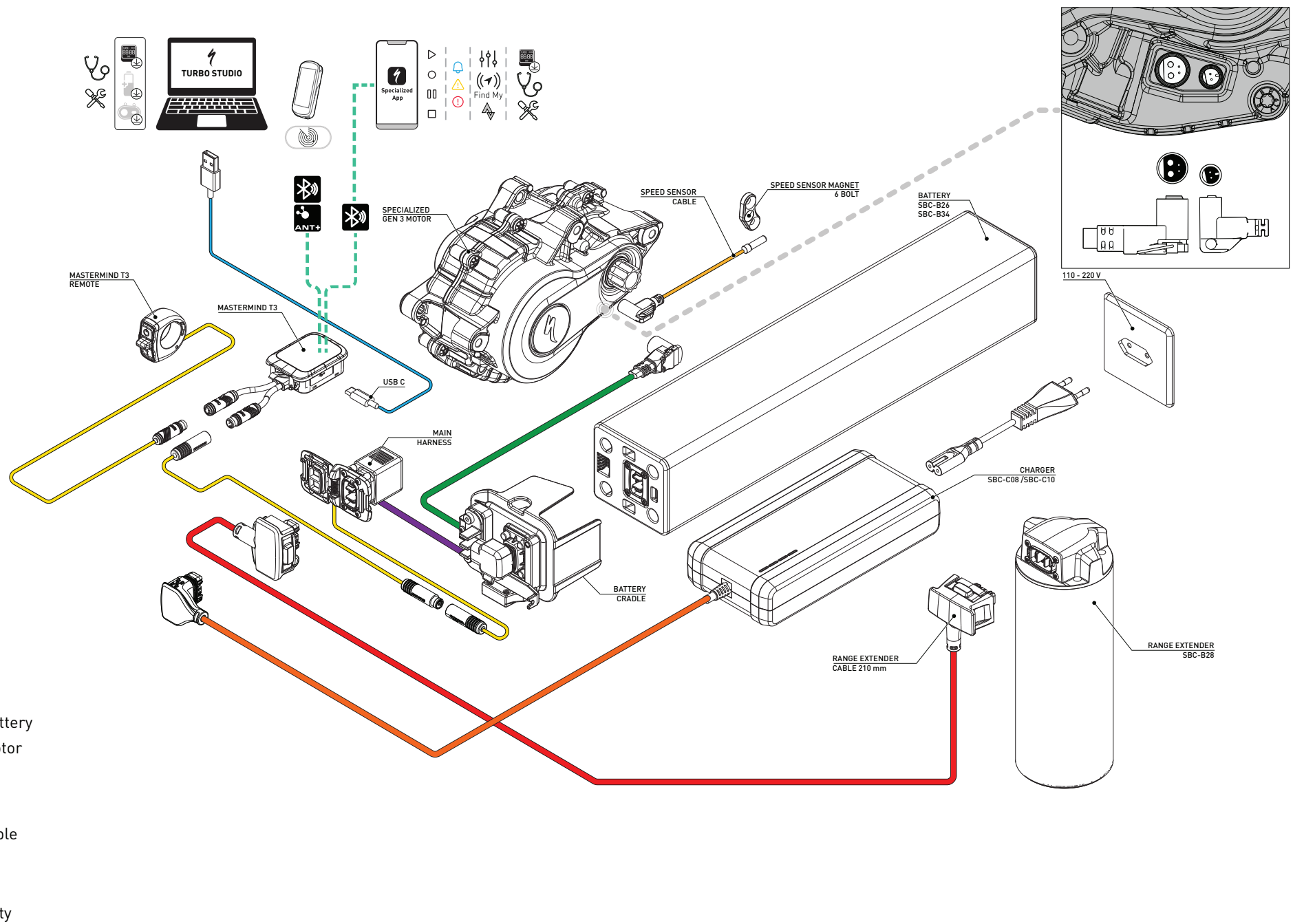

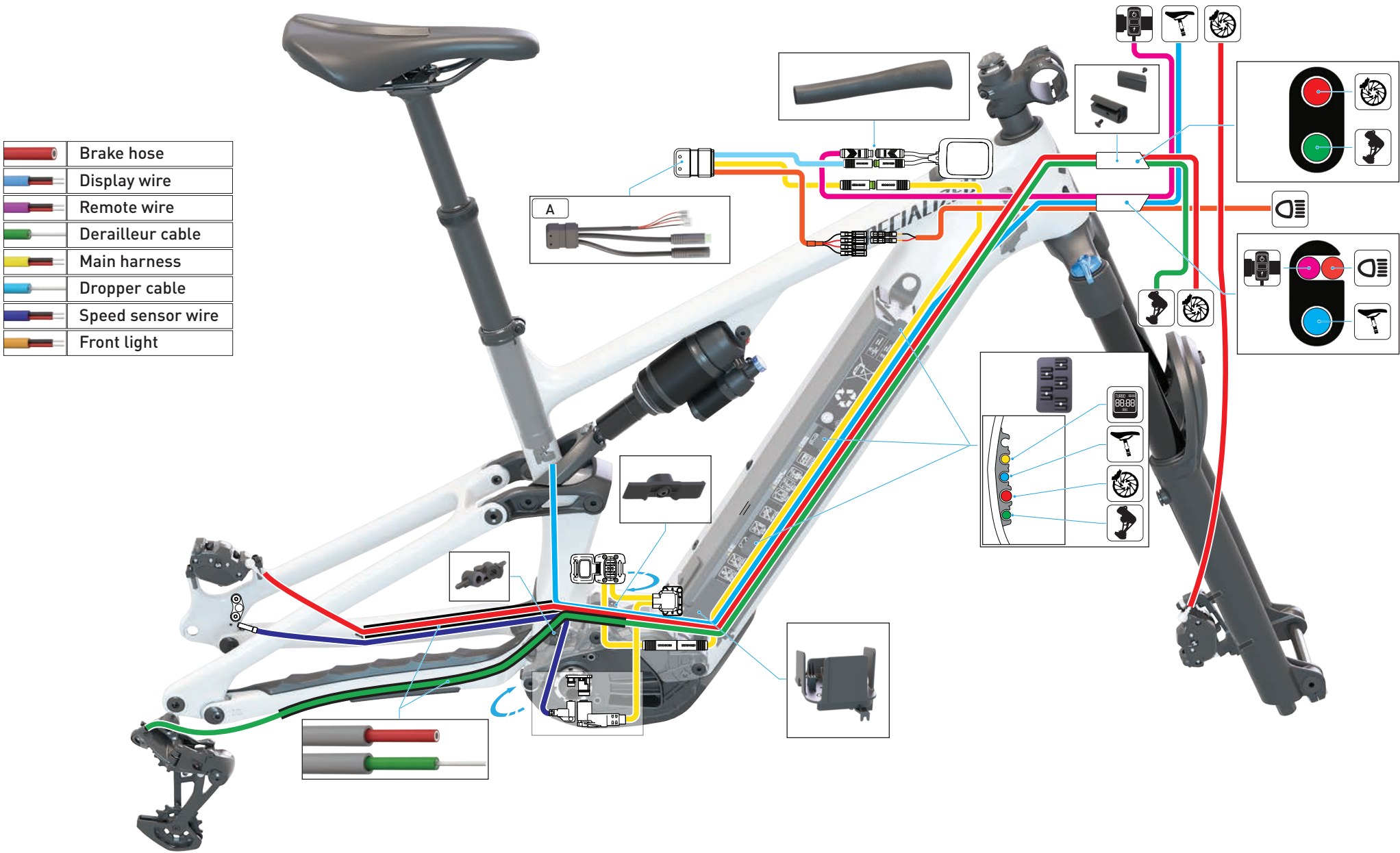

	PART NAME	PART #	ALT PART #	QTY	DESCRIPTION	TOOL	TORQUE		NOTES
							Nm	in-lbf	
A	Y-Splitter for lights	<a href="#">S256800002</a>		1	ELE WIRING, SPECIALIZED FULL POWER 3.1 SYSTEM, Y-SPLITTER FOR WIRED LIGHTS				

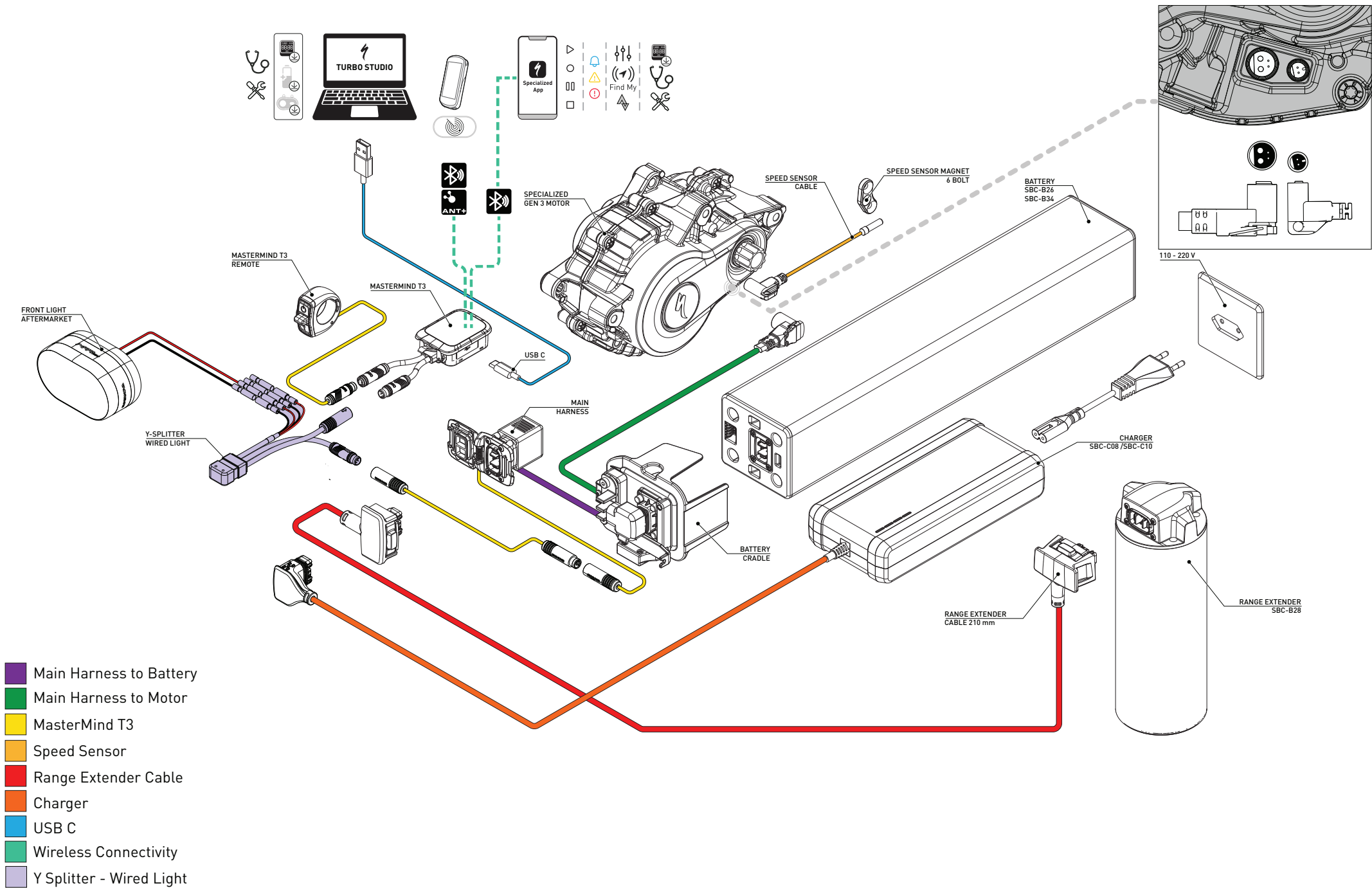

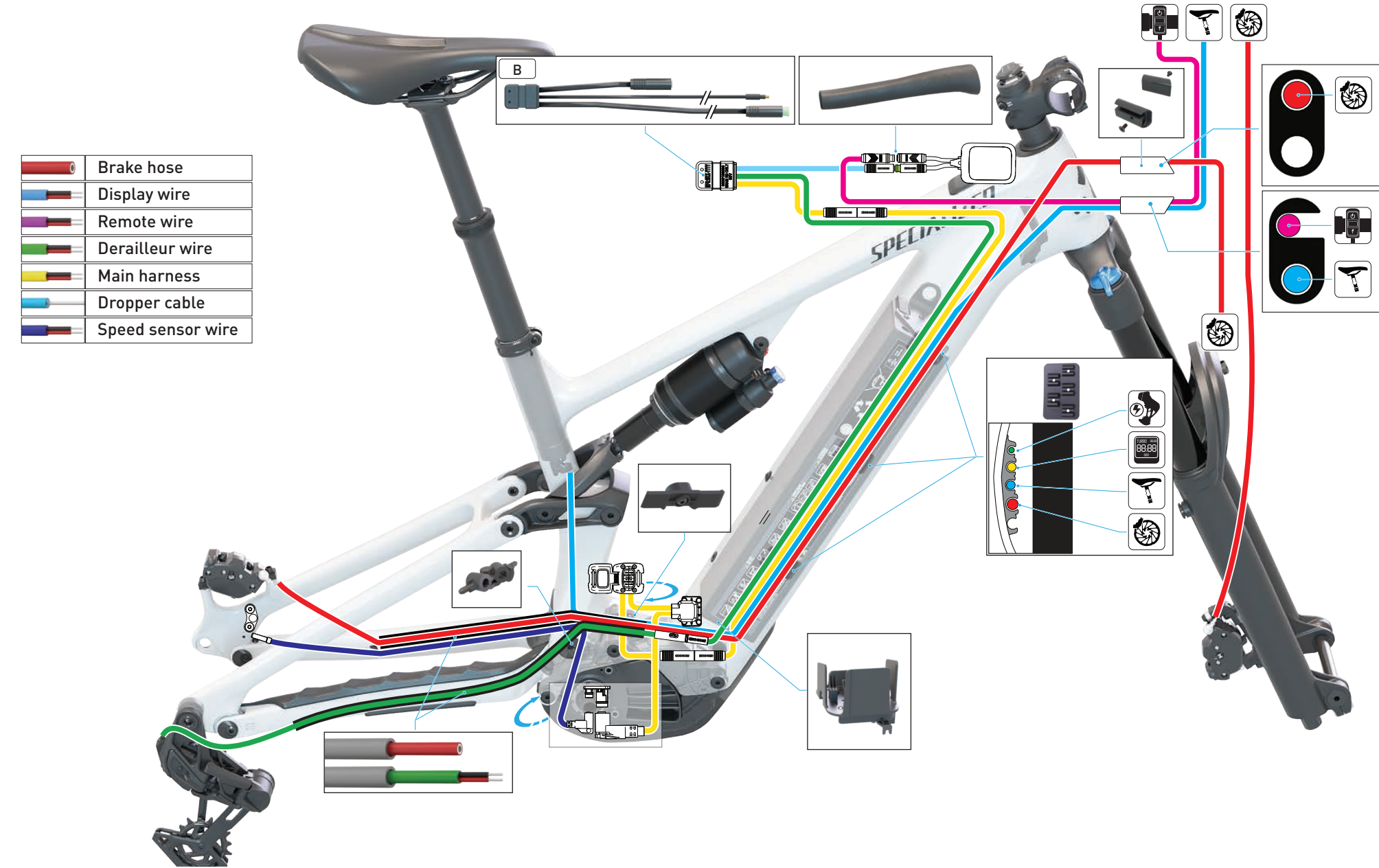

	PART NAME	PART #	ALT PART #	QTY	DESCRIPTION	TOOL	TORQUE		NOTES
							Nm	in-lbf	
B	Y-Splitter for Wired AXS Derailleur	<a href="#">S246800020</a>		1	CA,SPLTR,SRAM,AXS,60V,1000MM				



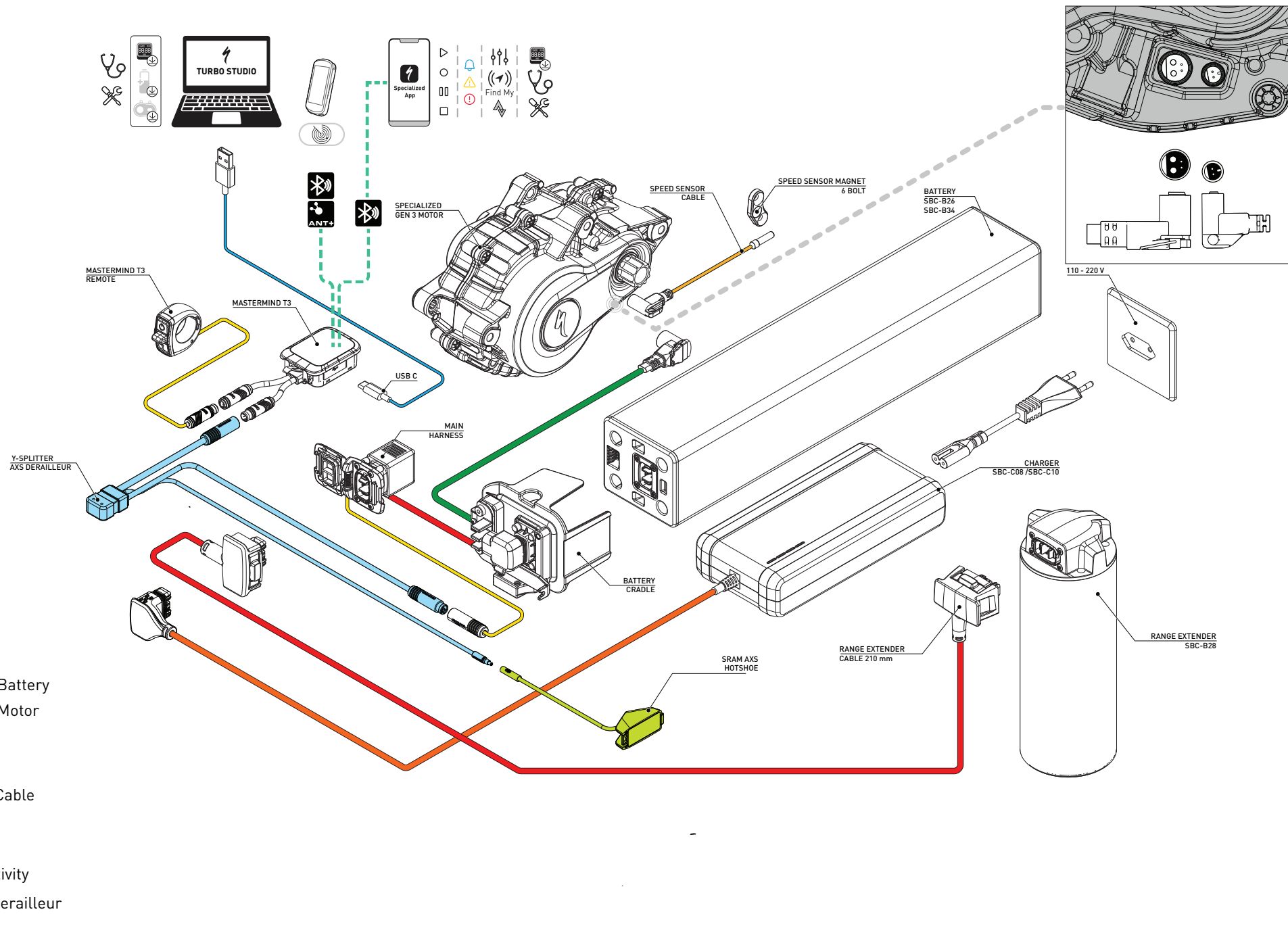

#### 11.4.AXS EQUIPPED - WITH LIGHT

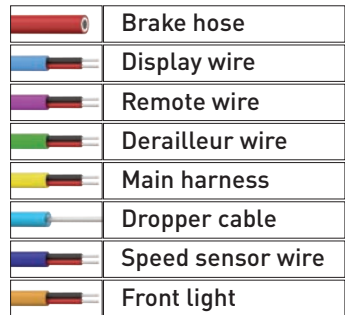

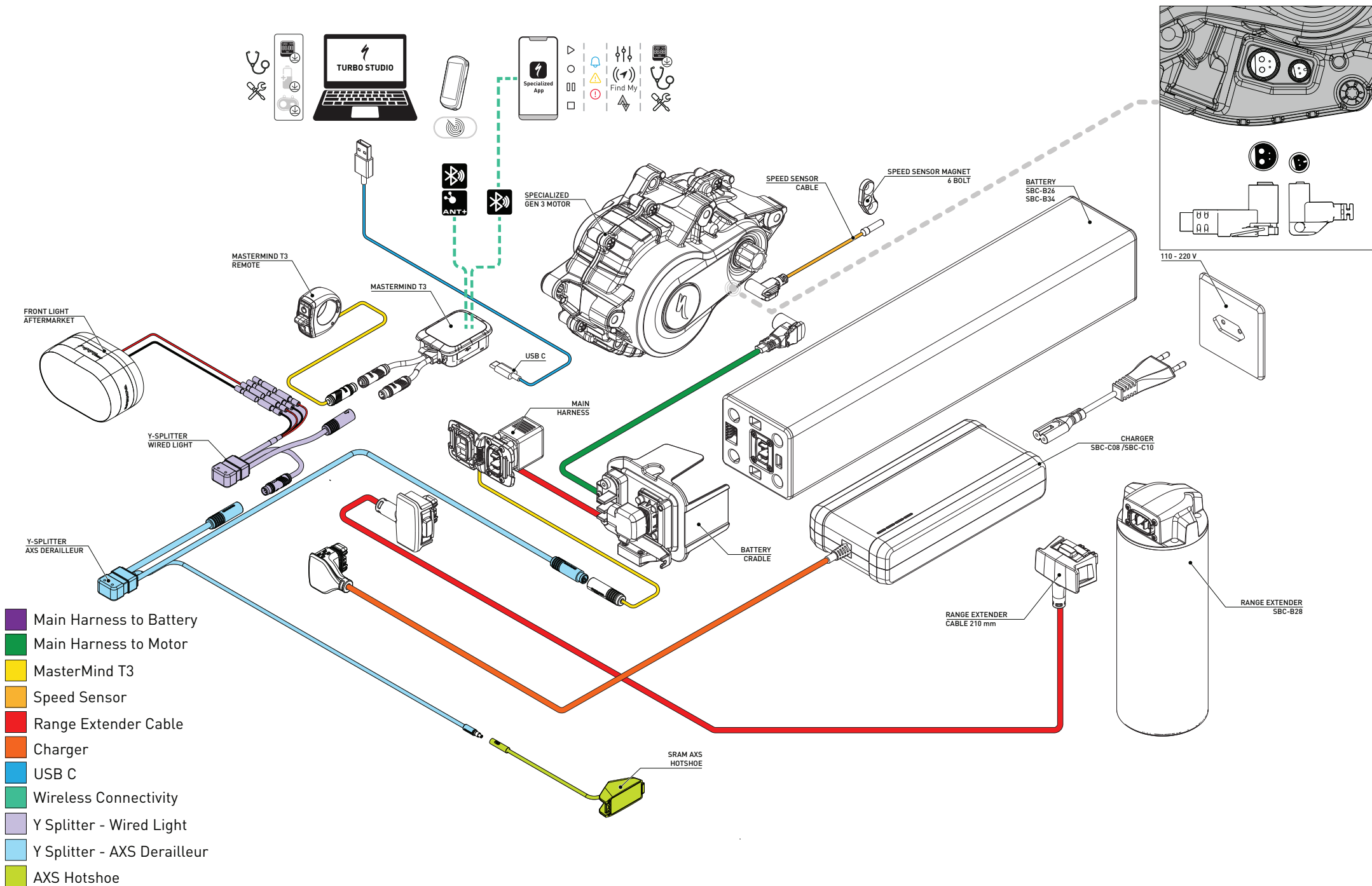

## 12. WHEELS AND HUBS

### 12.1. LEVO ALLOY / LEVO COMP ALLOY / LEVO COMP CARBON

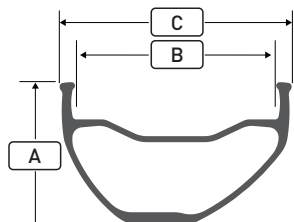
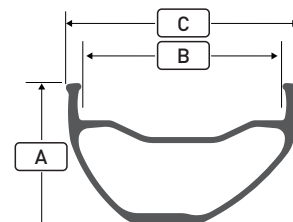
SPECIFICATION		FRONT		REAR	
Model Number					
Colorway		Anodised /Smoke			
Wheel Size		29"		27.5"	
E.T.R.T.O. / Bead Seat Diameter		622 mm		584 mm	
ERD		594 mm		556 mm	
Rim Construction		Clincher with zero bead hook design		Clincher with zero bead hook design	
Rim Material		6082 T6 Alloy			
Brake Compatibility		Disc 6-bolt			
Tubeless Compatibility		Yes			
Rim		Traverse HD, 29 " Alloy, 28h		Traverse HD, 27.5" Alloy, 32h	
Rim Holes		28 h / 6.2 mm Valve Hole		32 h / 6.2 mm Valve Hole	
Rim Dimensions	A: Depth	21.6 mm		21.6 mm	
	B: Internal Width	30 mm		30 mm	
	C: External Width	34,6 mm		34,6 mm	
Valve Type		Presta			
Valve Length		40 mm			
Hub Type		Alloy, sealed cartridge bearings, 15 x110 mm thru-axle, 28 h		Alloy, sealed cartridge bearings, 12 x148 mm thru-axle, 32 h	
Hub Bearing Type		Sealed cartridge bearing		Sealed cartridge bearing	
Hub Spacing		110 mm		148 mm	
Brake Type		Disc 6-bolt		Disc 6-bolt	
Bearing Dimensions	DS	18307 (18 x 30 x 7mm)		6902 (15 x 28 x 7mm)	
	NDS	18307 (18 x 30 x 7mm)		6902 (15 x 28 x 7mm)	
Driver Body Type		-		3-Pawl	
Freehub Body Type		-		Shimano HG	

	SPECIFICATION		FRONT	REAR
	Spoke Type		J Bend	
	Spoke Model		DT Swiss Elemental	
	Lacing Pattern		2 x lacing	
	Spoke Count		28 - 14:14	32 - 16:16
	Spoke length	DS	282 mm	269 mm
		NDS	281 mm	271 mm
	Nipples		Dt Swiss Brass Lead Free	
	Nipple Size		2 mm x12 mm (1g)	
	Approved Tire Widths		2.3 " - 2.6 "	
	Max Rim Pressure *	Tire Size 24 - 35 mm	40 psi	40 psi
		Tire Size 36 - 38 mm	40 psi	40 psi
	Max Weight Limit		300 lbs. / 136 kg.	
	Rim Tape Width		DT, tubeless compatible, 32 mm wide	

\*Always adhere to the max tire pressure of the used tire.

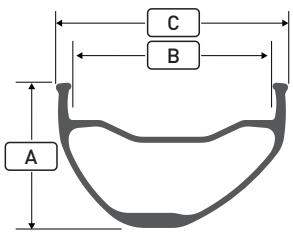
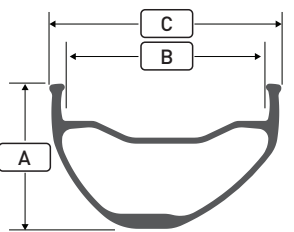

12.2.LEVO EXPERT CARBON

SPECIFICATION		FRONT		REAR	
Model Number		Traverse HD Alloy 370 29"		Traverse HD Alloy 370 27.5"	
Colorway		Black Anodised / Satin Black Decal			
Wheel Size		29"		27.5"	
E.T.R.T.O. / Bead Seat Diameter		622 mm		584 mm	
ERD		594 mm		556 mm	
Rim Construction		Clincher with zero bead hook design		Clincher with zero bead hook design	
Rim Material		6082 T6 Alloy			
Brake Compatibility		Disc 6-bolt			
Tubeless Compatibility		Yes			
Rim		Traverse HD, 29 " Alloy, 28h		Traverse HD, 27.5" Alloy, 32h	
Rim Holes		28 h / 6.2 mm Valve Hole		32 h / 6.2 mm Valve Hole	
Rim Dimensions	A: Depth	21.6 mm		21.6 mm	
	B: Internal Width	30 mm		30 mm	
	C: External Width	34,6 mm		34,6 mm	
Valve Type		Presta			
Valve Length		40 mm			
Hub Type		DT SWISS 370		DT SWISS 370	
Hub Bearing Type		Sealed cartridge bearing		Sealed cartridge bearing	
Hub Spacing		110 mm		148 mm	
Brake Type		Disc 6-bolt		Disc 6-bolt	
Bearing Dimensions	DS	6902 (15 x 28 x 7mm)		6902 (15 x 28 x 7mm)-	
	NDS	6902 (15 x 28 x 7mm)		6902 (15 x 28 x 7mm)-	
Driver Body Type		-		-	
Freehub Body Type		-		DT Swiss Ratchet LN	
Spoke Type		J Bend			
Spoke Model		Sapim Force Spokes			
Lacing Pattern		2-Cross (Tucked)			

SPECIFICATION		FRONT	REAR
Spoke Count		28 - 14:14	32 - 16:16
Spoke length	DS	283 mm	270 mm
	NDS	281 mm	270 mm
Nipples		Sapim Double Square 2.0 mm brass nipple	
Nipple Size		2 mm x18 mm	
Approved Tire Widths		2.3"-2.6"	
Max Rim Pressure *		40 PSI	40 PSI
Max Weight Limit		275 lbs / 125 kg	
Rim Tape Width		DT, tubeless compatible, 32 mm wide	

\*Always adhere to the max tire pressure of the used tire.

12.3.LEVO PRO CARBON

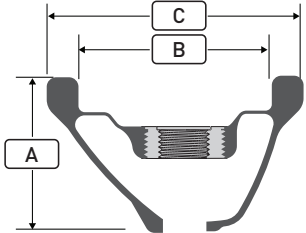
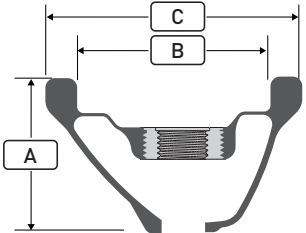
SPECIFICATION		FRONT		REAR			
Model Number		Traverse HD 350		Traverse HD 350			
Colorway		Satin Carbon / Black Decal					
Wheel Size		29"		27.5"			
E.T.R.T.O. / Bead Seat Diameter		622 mm		584 mm			
ERD		586.5 mm		548.5 mm			
Weight		806g		995g			
Rim Construction		Clincher with zero bead hook design		Clincher with zero bead hook design			
Rim Material		Carbon					
Brake Compatibility		Disc (Center Lock)					
Tubeless Compatibility		Roval Tubeless Valve Stem - 37 mm, for Threaded Valve Hole					
Rim		Traverse HD, 29 " Carbon, 28h		Traverse HD, 27.5" Carbon, 32h			
Rim Holes		28 h / 6.4 mm Valve Hole		32 h / 6.4 mm Valve Hole			
Rim Dimensions	A: Depth	24 mm			24 mm		
	B: Internal Width	30 mm			30 mm		
	C: External Width	40 mm			40 mm		
Valve Type		Presta / Custom threaded tubeless valve					
Valve Length		37 mm					
Hub Type		DT SWISS 350		DT SWISS 350			
Hub Bearing Type		Sealed cartridge bearing		Sealed cartridge bearing			
Hub Spacing		110 mm		148 mm			
Brake Type		Disc 6-bolt		Disc 6-bolt			
Bearing Dimensions	DS	6902 (15 x 28 x 7mm)		6902 (15 x 28 x 7mm)			
	NDS	6902 (15 x 28 x 7mm)		6902 (15 x 28 x 7mm)			
Driver Body Type		-		-			
Freehub Body Type		-		DT Swiss Star Ratchet			
Spoke Type		J Bend					
Spoke Model		DT Swiss Competition Race					

	SPECIFICATION		FRONT	REAR
	Lacing Pattern		2-Cross (Tucked)	
	Spoke Count		28 - 14:14	32 - 16:16
	Spoke length	DS	285 mm	263 mm
		NDS	281 mm	262 mm
	Nipples		DT Swiss, Pro Lock Hexagonal, Alloy, 14G,	
	Nipple Size		2 mm x 14 mm	
	Approved Tire Widths		2.3"-2.6"	
	Max Rim Pressure *		40 PSI	40 PSI
	Max Weight Limit		275 lbs / 125 kg	
	Rim Tape Width		Roval Tubeless Rim Tape, 32 mm wide	

\*Always adhere to the max tire pressure of the used tire.

12.4.LEVO S-WORKS CARBON

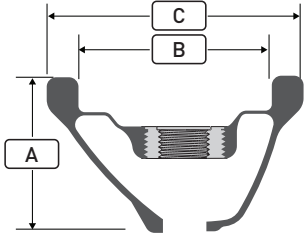
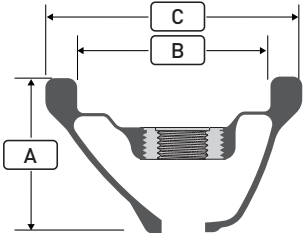
SPECIFICATION			FRONT		REAR	
Model Number			Traverse HD 240 DEG		Traverse HD 240 DEG	
Colorway			Satin Carbon / Black Decal			
Wheel Size			29"		27.5"	
E.T.R.T.O. / Bead Seat Diameter			622 mm		584 mm	
ERD			586.5 mm		548.5 mm	
Weight			768 g		938 g	
Rim Construction			Clincher with zero bead hook design		Clincher with zero bead hook design	
Rim Material			Carbon			
Brake Compatibility			Disc (Center Lock)			
Tubeless Compatibility			Roval Tubeless Valve Stem - 37 mm, for Threaded Valve Hole			
Rim			Traverse HD, 29 " Carbon,, 28h		Traverse HD, 27.5" Carbon, 32h	
Rim Holes			28 h / 6.4 mm Valve Hole		32 h / 6.4 mm Valve Hole	
Rim Dimensions	A: Depth	24 mm			24 mm	
	B: Internal Width	30 mm			30 mm	
	C: External Width	40 mm			40 mm	
Valve Type			Presta / Custom threaded tubeless valve			
Valve Length			37 mm			
Hub Type			DT SWISS 240		DT SWISS 240	
Hub Bearing Type			Sealed cartridge bearing		Sealed cartridge bearing	
Hub Spacing			110 mm		148 mm	
Brake Type			Disc 6-bolt		Disc 6-bolt	
Bearing Dimensions	DS	1728 (17 x 28 x 7 mm)		1526 (15 x 26 x 7 mm)		
	NDS	1728 (17 x 28 x 7 mm)		1526 (15 x 26 x 7 mm)		
Driver Body Type			-		-	
Freehub Body Type			-		DT Swiss Ratchet DEG	
Spoke Type			J Bend			
Spoke Model			DT Swiss Revolite			

	SPECIFICATION		FRONT	REAR
	Lacing Pattern		2-Cross (Tucked)	
	Spoke Count		28 - 14:14	32 - 16:16
	Spoke length	DS	283 mm	269 mm
		NDS	280 mm	271 mm
	Nipples		DT Swiss, Pro Lock Hexagonal, Alloy, 14G,	
	Nipple Size		2 mm x 14 mm	
	Approved Tire Widths		2.3"-2.6"	
	Max Rim Pressure *		40 PSI	40 PSI
	Max Weight Limit		275 lbs / 125 kg	
	Rim Tape Width		Roval Tubeless Rim Tape, 32 mm wide	

\*Always adhere to the max tire pressure of the used tire.

## 12.5. LEVO S-WORKS LTD CARBON

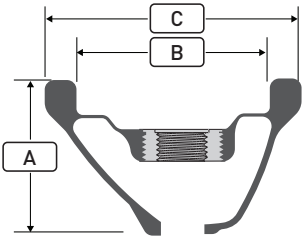
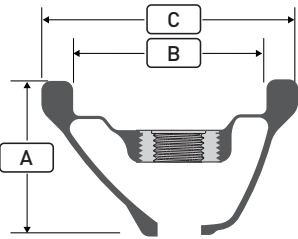
SPECIFICATION			FRONT		REAR	
Model Number			WH-TRAVERSE HD HYDRA		WH-TRAVERSE HD HYDRA	
Colorway			Raw Carbon / Black Decal			
Wheel Size			29"		27.5"	
E.T.R.T.O. / Bead Seat Diameter			622 mm		584 mm	
ERD			586.5 mm		548.5 mm	
Rim Construction			Clincher with zero bead hook design		Clincher with zero bead hook design	
Rim Material			Carbon			
Brake Compatibility			Disc 6-Bolt			
Tubeless Compatibility			Roval Tubeless Valve Stem - 37 mm, for Threaded Valve Hole			
Rim			Traverse HD, 29 " Carbon, 28h		Traverse HD, 27.5" Carbon,, 32h	
Rim Holes			28 h / 6.4 mm Valve Hole		32 h / 6.4 mm Valve Hole	
Rim Dimensions	A: Depth	24 mm			24 mm	
	B: Internal Width	30 mm			30 mm	
	C: External Width	40 mm			40 mm	
Valve Type			Presta / Custom threaded tubeless valve			
Valve Length			37 mm			
Hub Type			Industry 9 Hydra 2		Industry 9 Hydra 2	
Hub Bearing Type			Sealed cartridge bearing		Sealed cartridge bearing	
Hub Spacing			110 x 20 mm		148 mm	
Brake Type			Disc 6-bolt		Disc 6-bolt	
Bearing Dimensions	DS	61805 (25 x 37 x 7 mm)		61903 (17 x 30 x 7 mm)		
	NDS	61805 (25 x 37 x 7 mm)		61903 (17 x 30 x 7 mm)		
Driver Body Type			-		-	
Freehub Body Type			-		Industry Nine Hydra 2	
Spoke Type			J Bend			
Spoke Model			DT Swiss Revolite			
Lacing Pattern			2-Cross (Tucked)			

	SPECIFICATION		FRONT	REAR
	Spoke Count		28 - 14:14	32 - 16:16
	Spoke length	DS	283 mm	268 mm
		NDS	281 mm	270 mm
	Nipples		DT Swiss, Pro Lock Hexagonal, Alloy, 14G,	
	Nipple Size		2 mm x 14 mm	
	Approved Tire Widths		2.3"-2.6"	
	Max Rim Pressure *		40 PSI	40 PSI
	Max Weight Limit		275 lbs. / 125 kg	
	Rim Tape Width		Roval Tubeless Rim Tape, 32 mm wide	

\*Always adhere to the max tire pressure of the used tire.



13. ADDITIONAL SERVICE PARTS

	PART NAME	PART #	QTY	DESCRIPTION	NOTES
	SBC-C09 Fast Charger	98924-5640	1	TURBO 3.1 SMART CHARGER W/AUS CABLE	Supplied with S-Works Models
		98924-5641	1	TURBO 3.1 SMART CHARGER W/CHINA CABLE	
		98924-5642	1	TURBO 3.1 SMART CHARGER W/EU CABLE	
		98924-5643	1	TURBO 3.1 SMART CHARGER W/UK CABLE	
		98924-5644	1	TURBO 3.1 SMART CHARGER W/USA CABLE	
	SBC-C08/ SBC-C10 Standard Charger	98924-5645	1	TURBO 3.1 STANDARD CHARGER W/AUS CABLE	
		98924-5646	1	TURBO 3.1 STANDARD CHARGER W/CHINA CABLE	
		98924-5647	1	TURBO 3.1 STANDARD CHARGER W/EU CABLE	
		98924-5648	1	TURBO 3.1 STANDARD CHARGER W/UK CABLE	
		98924-5649	1	TURBO 3.1 STANDARD CHARGER W/USA CABLE	
	Cable Binder	<a href="#">S256500001</a>	1	CBG CABLE CLIP, CLEAN COCKPIT CABLE BINDER, FOR 5MM/3MM CABLES, PLASTIC (1 PCS.) (CC1028DB-J)	
	Driveside Seatstay Inner Foam Protector	<a href="#">S199900019</a>	1	MSC PROTECTOR, DRIVESIDE SEATSTAY INNER FOAM PROTECTOR, W/ ADHESIVE BACKING	
	Seatpost Shim	<a href="#">S174900001</a>	1	STP SUB, SEATPOST SHIM, 34.9MM OD - 30.9MM ID	
	Tubeless Valve Stem	<a href="#">S225500057</a>	1	WHL SUB, ROVAL TUBELESS VALVE STEM - 37MM, FOR THREADED VALVE HOLE (1 PCS.)	S-Works & Pro Models Only
	Downtube Cable Guide	<a href="#">S246500006</a>	1	CBG CABLE CHANNEL, LEVO 4, DOWNTUBE INTERNAL CABLE CHANNEL, 5-CABLES, W/ ADHESIVE BACKING (1 PCS.)	3 Required
	Battery Diagnostic Cable	<a href="#">S256800001</a>	1	ELE BATTERY, SPECIALIZED FULL POWER 3.1 SYSTEM, BATTERY DIAGNOSTIC ADAPTER CABLE	
	Battery Connector Downtube Cover	<a href="#">S246800008</a>	1	ELE COVER, LEVO 4, BATTERY CONNECTOR DOWNTUBE COVER	
	Shuttle Guard	<a href="#">S259900001</a>	1	MSC PROTECTOR, LARGE SHUTTLE GUARD, UPPER DOWNTUBE, RUBBER WITH ADHESIVE BACKING	
	Seatpost Clamp	<a href="#">S214700007</a>	1	STC 38.6MM SEATPOST CLAMP, BOLT-ON COLLAR (V3)	

13.1.BATTERY DOORS BY MODEL / COLOR

C	Levo S-Works	<a href="#">S246800010</a>	Gloss Red Pearl / Black / Metallic White Silver	C	Levo Expert Carbon	<a href="#">S256800012</a>	Gloss Cypress Metallic / Silver Dust
	Levo S-Works	<a href="#">S246800011</a>	Gloss Glacial Metallic / Red Pearl / Black Pearl		Levo Expert Carbon	<a href="#">S256800013</a>	Satin Burnt Gold Metallic / Doppio
	Levo S-Works	<a href="#">S256800017</a>	Gloss Laurel Green / Burnt Gold / Chrome		Levo Expert Carbon Warranty Frame	<a href="#">S256800014</a>	Gloss Birch / Taupe
	Levo S-Works Frameset	<a href="#">S246800012</a>	Satin Taupe / Gunmetal Strata / Metallic Obsidian		Levo Expert Carbon Warranty Frame	<a href="#">S256800015</a>	Satin Rusted Red / Redwood
	Levo Pro	<a href="#">S246800014</a>	Gloss Blue Onyx / Dark Navy / Brich		Levo Alloy	<a href="#">S256800004</a>	Gloss Deep Orange / Deep Lake
	Levo Pro	<a href="#">S246800031</a>	Gloss Metallic Obsidian / Burnt Gold Metallic		Levo Alloy	<a href="#">S256800005</a>	Gloss Metallic Obsidian / Silver Dust
	Levo S-Works Warranty Frame	<a href="#">S246800013</a>	Gloss Oak Green / Dark Moss Green		Levo Alloy	<a href="#">S256800006</a>	Satin Cypress Metallic / Dark Moss Green
	Levo S-Works Warranty Frame	<a href="#">S246800009</a>	Satin Mystic Blue / Morning Mist		Levo Comp Alloy	<a href="#">S256800007</a>	Gloss Deep Lake Metallic / Dune White
	Levo S-Works LTD	<a href="#">S246800030</a>	Astral Blue / Dark Navy / Chrome Strata		Levo Comp Alloy	<a href="#">S256800008</a>	Satin Dusky Pink / Cypress Metallic
	Levo Comp Carbon	<a href="#">S256800010</a>	Gloss Orange Tint Over Silver Dust / Dark Navy		Levo Comp Alloy	<a href="#">S256800009</a>	Satin Gunmetal / Obsidian
	Levo Comp Carbon	<a href="#">S256800011</a>	Satin Champagne / Metallic Obsidian				



***SPECIALIZED***

**SPECIALIZED BICYCLE COMPONENTS**  
15130 Concord Circle, Morgan Hill, CA 95037 (408) 779-6229